

**PLAN 5 Site AV68 Skelton Grange South showing existing & new proposed amendments**

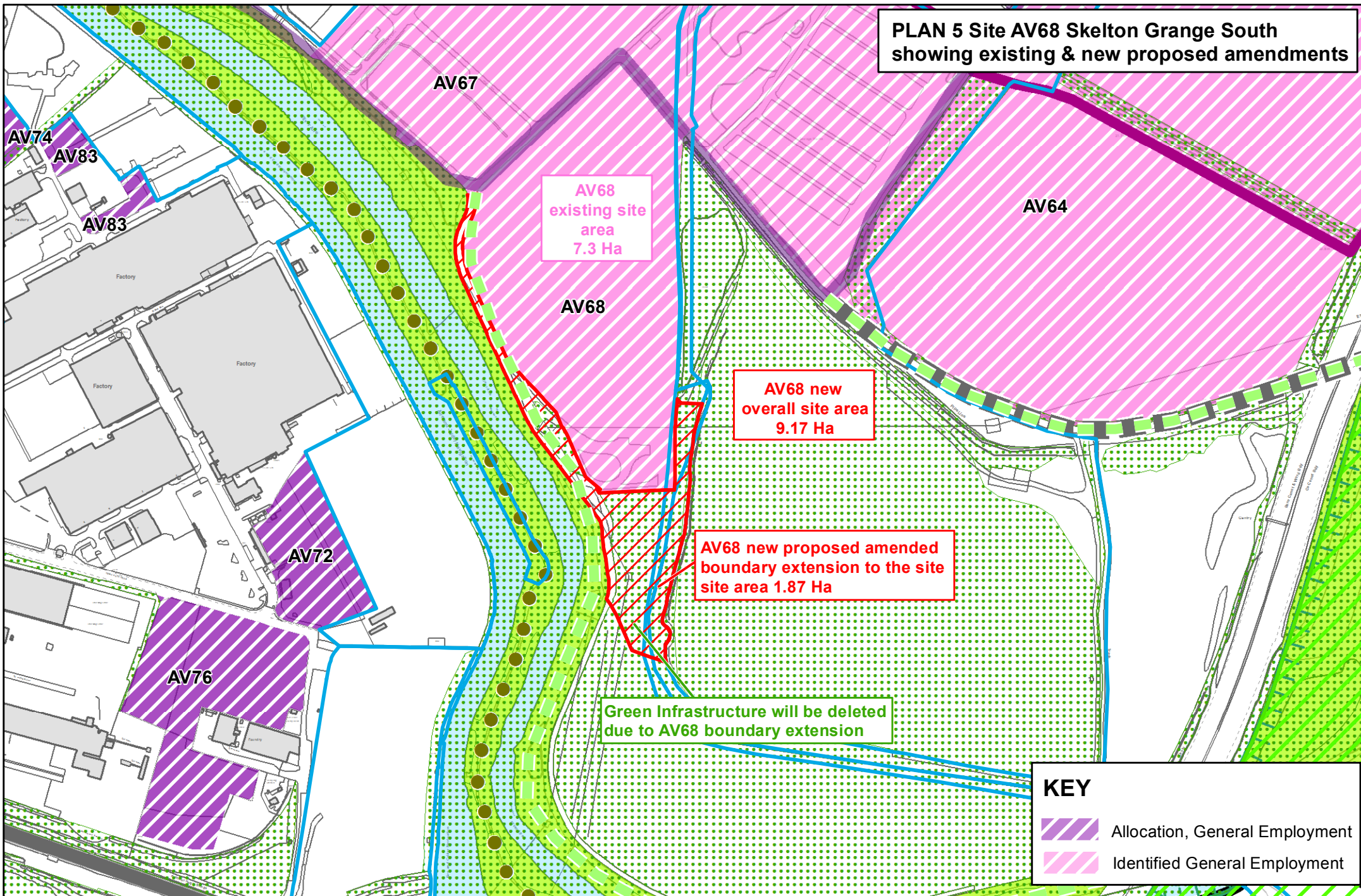



AV68  
existing site area  
7.3 Ha

AV68 new  
overall site area  
9.17 Ha

AV68 new proposed amended  
boundary extension to the site  
site area 1.87 Ha

Green Infrastructure will be deleted  
due to AV68 boundary extension

**KEY**

-  Allocation, General Employment
-  Identified General Employment